

User manual and parts handbook Verti-Top

Serial number:

Redexim
Charterhouse

REDEXIM BV
INTERNATIONAL TRADING
KWEKERIJWEG 8
3709 JA ZEIST HOLLAND
TEL (31) 30 6933227
FAX (31) 30 6933228
VERTI-DRAIN@REDEXIM.COM
WWW.REDEXIM.COM

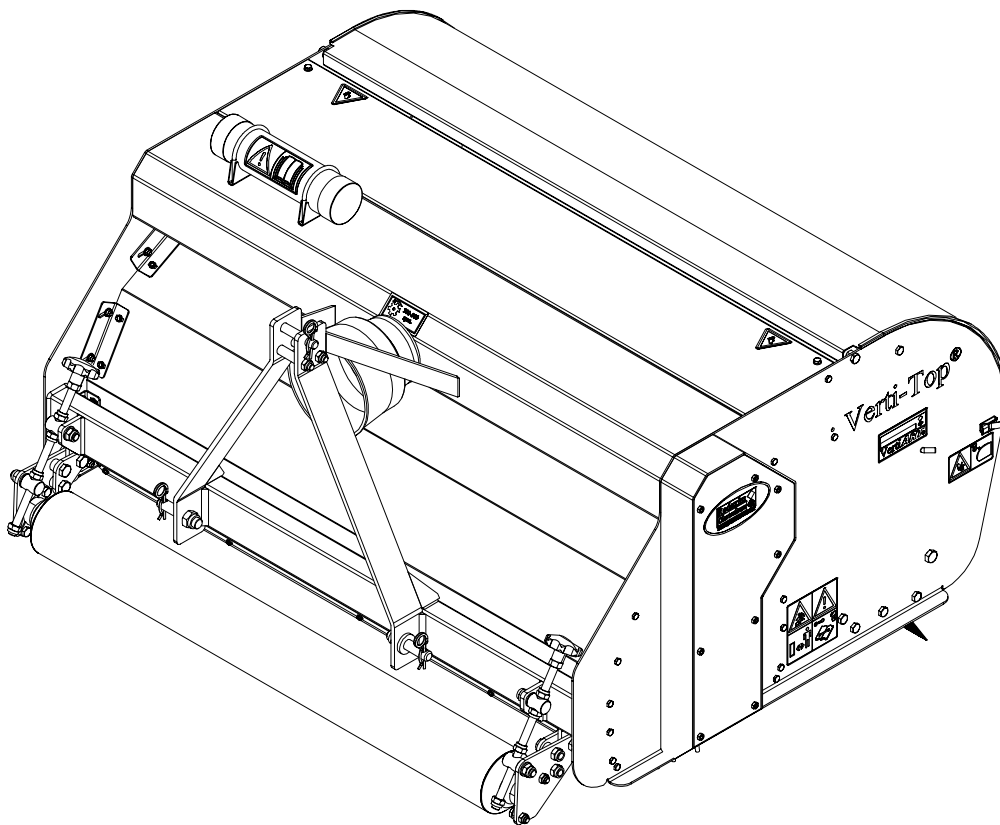

ATTENTION:

TO ENSURE SAFE USE OF THIS MACHINE AND TO BE ABLE TO ACHIEVE THE BEST RESULTS, IT IS OF THE UTMOST IMPORTANCE TO READ THIS USER MANUAL THOROUGHLY BEFORE USING THE VERTI-TOP.

FOREWORD

Congratulations on your purchase of the Verti-Top. To ensure the long and safe use of this Verti-Top, it is of the utmost importance for all those who will be using it to read and understand this user manual.

Operation of this machine is not safe without full knowledge of the content of the manual.

The Verti-Top is not an independently operating machine. The user is responsible for using the appropriate tractor. The user must also check the tractor/Verti-Top combination for safety aspects such as the noise level, adequate user instructions, and possible risk factors.

On the next page you will first find the general safety instructions. Every user must know and apply them. After this, a registration card is included. This card should be returned for handling any future claims.

This user manual offers many instructions numbered in sequence. This sequence should be observed. An asterisk * indicates a safety instruction. An @ indicates a tip and/or note.

GUARANTEE CONDITIONS

THIS VERTI-TOP IS DELIVERED WITH A WARRANTY AGAINST DEFECTS IN MATERIALS. THIS GUARANTEE IS VALID FOR A PERIOD OF 12 MONTHS FROM THE PURCHASING DATE. VERTI-TOP WARRANTIES ARE SUBJECT TO THE "GENERAL CONDITIONS FOR SUPPLY OF PLANT AND MACHINERY FOR EXPORT, NUMBER 188", WHICH ARE PUBLISHED UNDER THE AUSPICES OF THE UNITED NATIONS ECONOMIC COMMISSION FOR EUROPE.

REGISTRATION CARD

For your own information, please complete the table below:

Serial number of machine	
Dealer name	
Purchasing date	
Remarks	

! SAFETY INSTRUCTIONS !

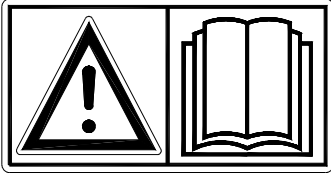
 <p>Fig. 1</p>	<p>The design of the Verti-Top allows for safe use. However, this is only possible if the user fully observes the safety instructions given in this manual.</p> <p>Read and understand (Fig. 1) the manual before starting to use the Verti-Top.</p> <p>If the machine is not used as described in the manual, injury and/or damage to the Verti-Top may result.</p>
---	---

- (1) The machine must only be used by professionals and must first be professionally adjusted for use on the ground that is to be treated.

The manufacturer does not accept any liability with regard to damage resulting from non-professional use; all resulting risks are the responsibility of the user. Correct/professional use also includes following the manufacturer's instructions for use, maintenance and repair.

Before using the Verti-Top, inspect the area to be treated.
Remove any loose obstacles and avoid irregularities.

- (2) The Verti-Top was constructed according to the latest technological knowledge and is safe to use.

Improper use, maintenance or repair of the machine may result in injury to both the user and others. **This should be avoided!**

Always use the Verti-Top in combination with the proper tractor as described in the technical data.

- (3) All persons whom the owner assigns to operate, maintain or repair the Verti-Top must read and have completely understood the operating manual and in particular the section **Safety Instructions**.

The user is responsible for a **safe tractor/Verti-Top combination**. **This unit must be tested** in terms of noise, safety and ease-of-use. In addition, user's instructions must be prepared.

- (4) Before using the Verti-Top, the user is **obliged** to inspect it for **visible damage and defects**.

Any changes in the Verti-Top (including its functioning) that may affect its safety must be corrected immediately.

For reasons of safety, it is in principle forbidden to make changes in or additions to the Verti-Top (with the exception of those approved by the manufacturer).

If any **modifications** have been made to the Verti-Top, the present CE certificate becomes null and void and the person who made the modifications should **himself** make sure a new **CE certificate** is granted.

Before each use, inspect the Verti-Top for loose bolts/nuts/parts.

If present, inspect the hydraulic hoses regularly and replace them if they are damaged or show signs of wear. The replacement hoses must meet the manufacturer's technical specifications.

Always relieve the pressure from the hydraulic installation, if present, before carrying out any work on it.

NEVER use de Verti-Top if its protective covers and safety decals are missing.

During use of the Verti-Top the inspection panel **MUST** be closed. (Fig. 2)

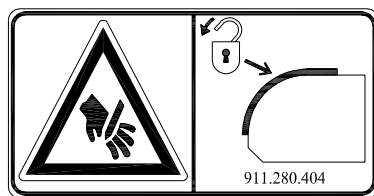

Fig. 2



Fig. 3

When opening the inspection panel **BE CAREFUL** not to get pinched (Fig. 3).

NEVER crawl underneath the Verti-Top.

If you need to access the bottom, tilt the Verti-Top.

NEVER step off the tractor while the engine is still running.

When carrying out maintenance, adjustments or repairs, make sure the Verti-Top is blocked from sagging/moving/sliding.

When carrying out any maintenance activities, adjustments or repairs, **always switch off the tractor engine first, remove the tractor key from the ignition and disconnect the PTO** (Fig.4).



Fig. 4

When carrying out any maintenance or repairs, make sure to use original Verti-Top parts only. This will ensure continued safety of the machine and its user.

Only authorised technical personnel may carry out adjustments and repair work to the Verti-Top.

Keep an overview of repairs.

- (5) In addition to the instructions in this user manual, the generally applicable regulations with respect to safety and working conditions must be observed.

For use on public roads the relevant traffic rules also apply.

Transporting persons is not permitted!

Do not use the Verti-Top when it is dark, during heavy rain/ storms, or on slopes with a gradient greater than 20 degrees.

- (6) Before starting to work, all persons who will operate the Verti-Top must be familiar with all its functions and controls.

Attach the Verti-Top according to the instructions on the tractor.

(Danger of injury!)

Before driving off, make sure you have a clear view both nearby and far away.

On both sides of the Verti-Top, safety stickers (Fig. 3, 4, 5) have been applied to the sideboards and to the back cover (Fig. 7) showing these warnings. Make sure these safety stickers are always clearly visible and legible. Replace them if they are damaged.

During operation, make sure there are **NO persons in the danger area** of the Verti-Top to prevent them from getting injured by ejected material (Fig. 5).



Fig. 5



Fig. 6

Keep a distance of at least 4 metres! (Fig. 6)

Be aware of the maximum lifting capacity of the towing vehicle.

Wear suitable clothing. Wear sturdy shoes with a steel tip, wear long trousers, do up long hair and wear no loose clothing.

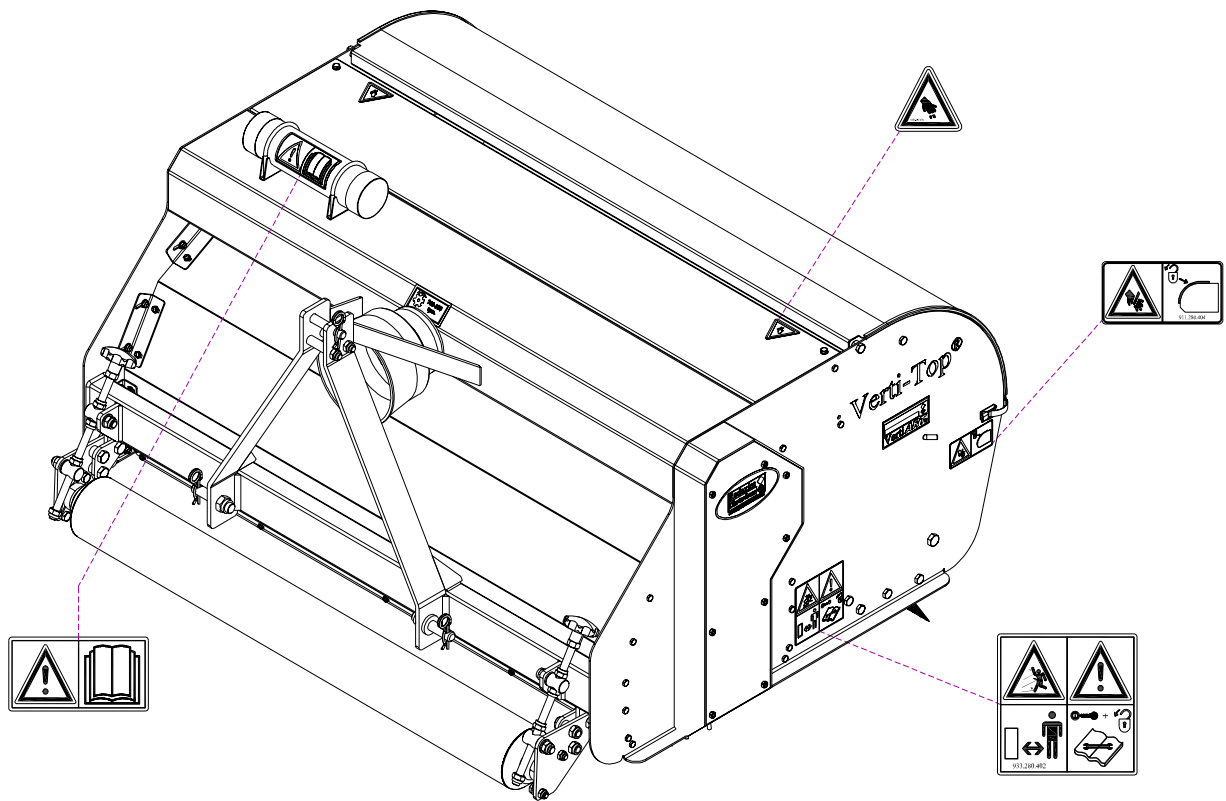

Fig. 7

(7) Location of safety stickers (Fig. 7)

CONTENTS

<i>Section</i>	<i>Description</i>	<i>Page</i>
	Foreword	2
	Guarantee conditions	2
	Registration card	2
	Safety instructions	3
1.0	Technical data	8
2.0	First installation, removing the machine from the pallet	9
3.0	General parts list	10
4.0	The PTO	11
4.1	Length of the PTO	11
4.2	Operation of the PTO	12
4.3	PTO information and maintenance	12
5.0	Connecting to the tractor	13
6.0	Adjusting the working depth	14
7.0	Angle adjustment of the sieve	14
8.0	Transportation of the Verti-Top	15
9.0	Driving speed	15
10.0	Operation of the Verti-Top	15
11.0	Start/stop procedure	16
12.0	Emptying the waste container	17
13.0	Operation of the Verti-Top	18
14.0	Troubleshooting	19
15.0	EU certificate	19
16.0	Maintenance	20
16.1	Adjusting V-belt tension	21
16.2	Adjusting brush guideplates	22
16.3	Exchanging the sieve	23
	Parts pages	

1.0 TECHNICAL DATA

Model	1500
Working width	1.47 m (57.8")
Working depth (with new brush)	0 mm - 26 mm (0"-1.02")
Driving speed	Max. 12 km/h (7.5 mph)
Weight	360 kg (793.7 lbs)
Recommended tractor	25 HP with minimum lifting capacity of 400 kg (881.9 lbs)
Volume of waste container	170 litres (6.0 cu. ft.)
Maximum capacity (Theoretically at maximum speed, 12 km/h (7.5 mph))	17,616 m ² /h (129,921 ft ² /h)
Mesh width of sieve (Included standard)	0.2 x 5mm (0.2"x 16")
Shipping dimensions	L x W x H 1309 x 1682 x 1050 mm 51.5" x 66.2" x 41.3"
Three-point connection	CAT. 1
Gearbox oil	SAE 90
Lubricant	EP 2
Standard parts	Front and back roller. Sieve, adjustable for degree of cleaning. Pivoting waste container. Adjustable brush guide covers. Integrated surface-following drag brush. PTO shaft. Manual container.
Options	Sieve elements with various opening sizes.

2.0 FIRST INSTALLATION, REMOVING THE MACHINE FROM THE PALLET

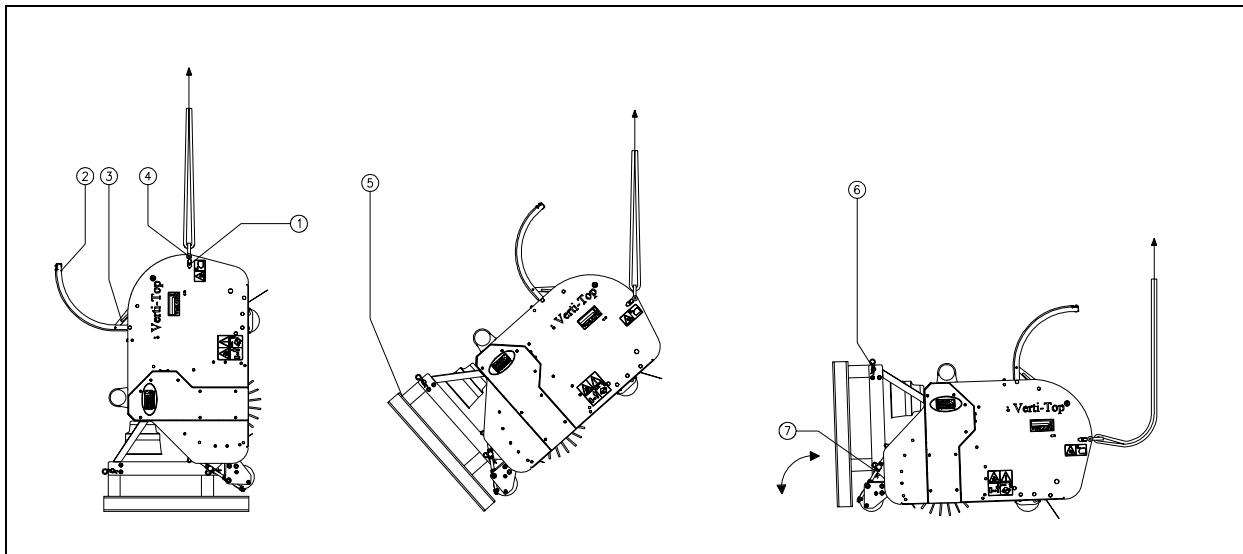

Fig. 8

The machine is standing vertically on the pallet. To remove the pallet and lay the machine horizontally on the ground, proceed as follows (see Fig. 8):

***!! DO NOT CRAWL UNDER THE MACHINE !!**

1. Open the covers 1 on both sides of the Verti-Top.
2. Open the inspection panel 2 and lock it in retaining strip 3.
3. Mount a cable to the lifting points 4 on both sides of the machine.

*** Make sure that the cable/crane/lift can lift at least 600 kg (1,323 lbs).**

4. Raise the machine, including the pallet, approx. 50 mm (2") from the ground.
5. Make sure that the machine is on the point of the pallet 5.
6. Gently lower the machine, in a controlled way, until it fully rests upon the ground.

***!! BE CAREFUL – KEEP YOUR DISTANCE – THE MACHINE MAY SHIFT !!**

7. Remove the top rod pin 6 and carefully rotate the pallet around the bottom 3-point pins 7 until they are resting on the ground.
8. Remove the bottom three-point pins 3 and remove the pallet.
9. Connect the machine to the tractor (see section 5.0).
*** Use the correct tractor. See the specifications.**
10. **Switch off the tractor and lock the tractor/Verti-Top combination to prevent it from driving/sliding away.**
11. Adjust the PTO to the Verti-Top tractor combination (See section 4.0).

3.0 GENERAL PARTS LIST

Figure 9 shows some important parts:

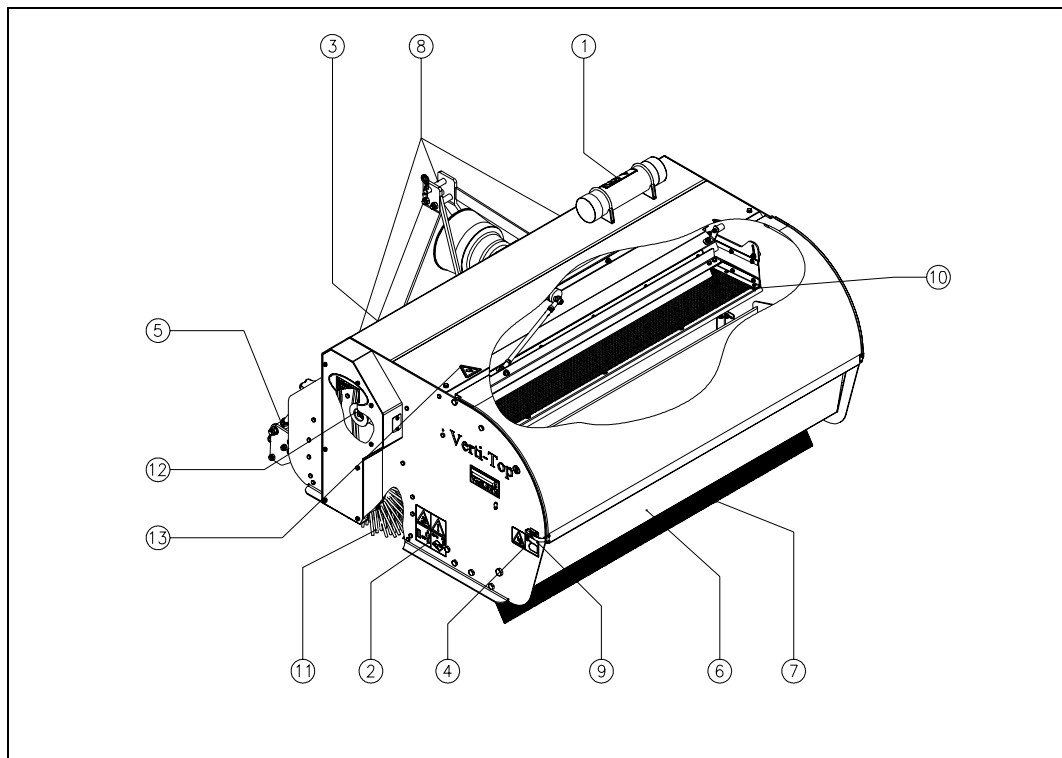

Fig. 9

1. Safety sticker 900.280.402: read user manual before use/toolbox.
2. Safety sticker 933.280.402: keep a distance of at least 4 metres from the machine. Stop the engine before carrying out repairs or adjustments. Be careful of flying debris.

* **Make sure all safety stickers are clearly visible on the machine and are understood.**

3. The serial number is located on the front of the machine.
4. Safety sticker 911.280.404: the inspection panel **MUST** be closed during use.
5. Adjustable front roller for working-depth adjustment.
6. Pivoting waste container.
7. Surface-following drag brush.
8. Three-point fastening pins.
9. Closure for inspection cover.
10. Sieve, adjustable for degree of cleaning.
11. Rotating brush.
12. Adjustable belt tensioner for rotating brush drive.
13. Safety sticker 900.280.404: **BE CAREFUL** not to get pinched.

4.0 The PTO

The PTO is a very important part. It provides the drive from the tractor and ensures safe use of the machine – if installed, used, and maintained correctly. The PTO has its own CE certificate. Make sure to read the PTO manual. It is located on the PTO itself.

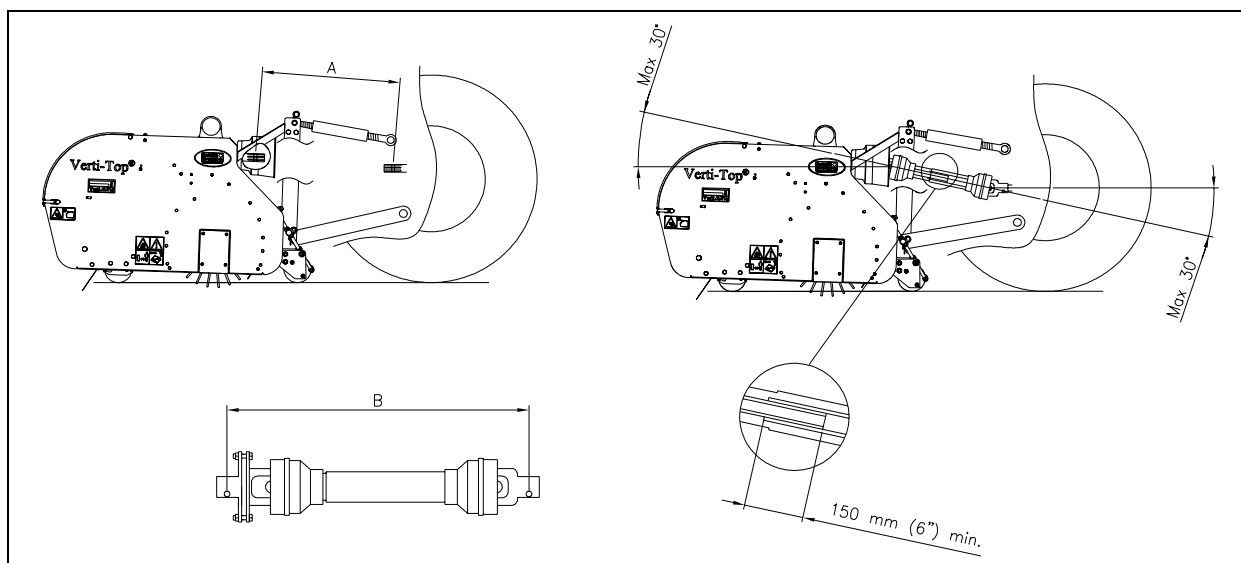

Fig. 10

4.1 LENGTH OF THE PTO (fig. 10)

The length of the PTO is very important. If it is too long, it may damage the drive of the tractor and/or the Verti-Top.

If the overlapping length of the sleeves is, at any time, shorter than 150 mm, the PTO may be damaged.

***!! The length will vary when the machine is raised or if another tractor is used !!**

To make sure the length of the PTO is correct, after purchase or when using another tractor, carry out the following steps:

1. Connect the Verti-Top to the tractor, as described in section 5.0.
2. *** !! Switch off the tractor and make sure the tractor is properly blocked and cannot start moving by itself !!**
3. Lower the Verti-Top to the ground until the front and rear rollers just touch the ground.
4. Measure the distance between the PTO connection of the tractor and that of the Verti-Top, from one furrow to the next.
5. Measure the distance B of the PTO at its shortest position, from locking pin to locking bolt.
6. Split the PTO in two and remove the protective cover from both ends.
7. Both the sleeve ends and the cover ends have to be shortened: $(B-A) + 75 \text{ mm (3")}$.
8. Deburr, grease, and assemble all parts.
9. Mount the PTO with the breaking bolt side facing the Verti-Top.
10. Mount the other end of the PTO to the tractor.
11. Check the overlap of the sleeves.

*** !! Never use the machine if the protective cover of the PTO is damaged.
Replace it first. !!**

4.2 OPERATION OF THE PTO

To ensure correct operation of the PTO, check the following items:

1. During operation of the Verti-Top, the angle between the points of rotation may not exceed 30 degrees.
2. The rotating points should be aligned.
3. The overlap of the sleeves must be at least 150 mm.
4. Never use the machine if the protective cover of the PTO is damaged.

4.3 PTO INFORMATION AND MAINTENANCE

Summarised PTO maintenance schedule.

Periodic maintenance:

- Grease the lubricating points after every 100 hours of operation or when the PTO has not been used for a while.
- Check the PTO for signs of damage to the protective covers and replace these if necessary.
- Make sure all safety stickers are present on the PTO and that they are undamaged.

Annual maintenance:

- Remove the PTO from the machine.
- Carefully check all parts of the PTO.
- Replace all parts that are damaged.
- Lay out all the parts and check them carefully.
If any parts show signs of damage or wear, replace them.
- Clean all parts that interlock or engage.
- Reassemble the parts.
- Grease both sleeves and reassemble the two PTO halves.
- Reassemble the PTO and mount it on the machine.

For further information concerning maintenance and assembly of the PTO, please refer to the manual included with the PTO.

@ If the PTO was shortened incorrectly, or if another tractor was used, the gearbox may be overloaded. This may result in damage.

5.0 CONNECTING TO THE TRACTOR

Inspection procedure before connection of the Verti-Top:

- Visually inspect the Verti-Top for signs of damage and repair these if they endanger a safe operation of the machine.
- Make sure that all nuts and bolts are properly tightened.
- Check whether all of the protective covers and safety stickers are present on the machine and undamaged.

The machine may **NEVER** be used if this is not the case.

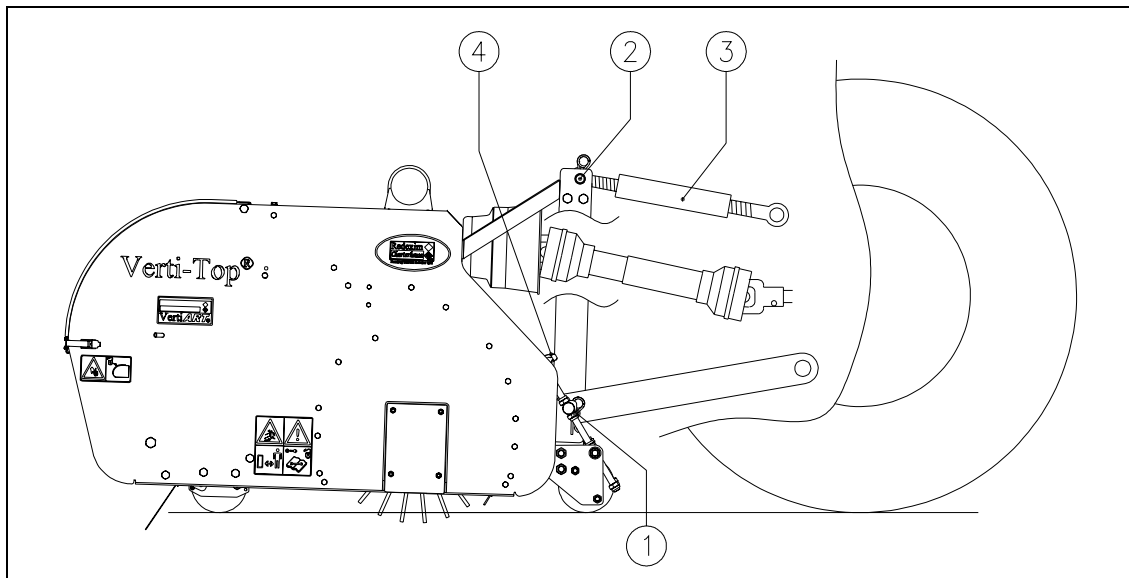

Fig. 11

The Verti-Top is connected to the tractor by means of the three-point connection.

This is done as follows: (Fig. 11)

1. Remove the three-point pins 1 and 2
2. Mount the PTO with the breaking bolt side facing the PTO shaft of the Verti-Top.
3. Drive the tractor carefully in reverse so that the low connection arms can be connected to the frame.
4. ***!! Ensure that the tractor is well blocked and cannot start moving by itself !!**
5. ***!! Switch off the tractor before getting off !!**
6. Connect the lower connecting arms to the three-point connecting plate pins 1 and secure these using the safety pins included.
7. Set the tractor's stabiliser to 100 mm of lateral movement.
8. Mount the top rod of your tractor and pull it out by turning it until it has reached the same level as the three-point stop connection of the Verti-Top.
9. Connect the top rod 3 with pin 2 to the frame. Secure pin 2 using the safety pin included.
10. Push the top rod in by turning in order to tension it.
11. Mount the PTO to the PTO shaft of the tractor.
12. ***!! Make sure that all mounting pins are securely locked!!**
13. Start the tractor and raise the Verti-Top from the ground.

6.0 ADJUSTING THE WORKING DEPTH

The working depth can be adjusted by turning the star knobs 4 (Fig. 11) on the front of the machine to adjust the front roller. Set both sides of the machine to the same height so the field will be cleaned as evenly as possible.

NEVER adjust the machine in such a manner that the ground surface might be damaged.

***! IMPORTANT!**

First check the working depth while the machine is stationary before using the machine!

7.0 ANGLE ADJUSTMENT OF THE SIEVE

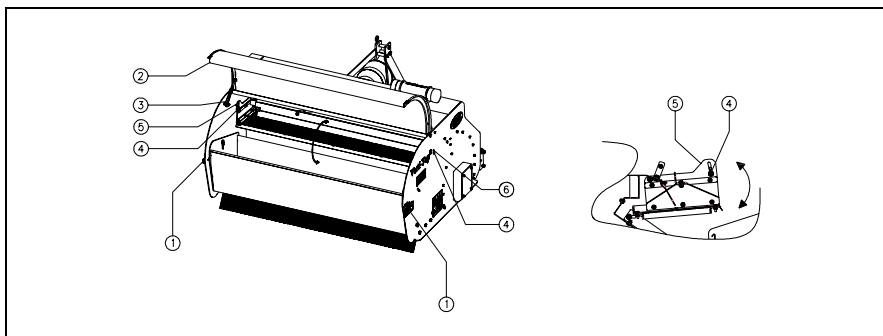

Fig. 12

If too much material is collected in the waste container, while it should have passed through the sieve, it is possible to give the sieve more time to sift out the material. This can be achieved by setting the sieve at an angle.

This works as follows (see Fig 12):

***!! Ensure that the tractor/Verti-Top is well blocked and cannot start moving by itself !!**
***!! Switch off the tractor before getting off !!**

1. Open the covers 1 on both sides of the Verti-Top.
2. Open the inspection panel 2 and lock it in retaining strip 3.

***!! Make sure the inspection cover is secured properly and cannot fall closed!!**

3. Loosen the bolts/nuts 4 on both sides of the machine.
4. Adjust the sieve 5 to the same angle on both sides.
5. Tighten the bolts/nuts 4 on both sides of the machine.
6. Unlock the inspection cover 2 from the retaining strip.
7. Carefully close the inspection cover 2.
8. Lock the inspection cover 2 with the closures 1 on both sides of the machine.

@ If more aggressive cleaning is desired, the bolts and nuts 4 can be repositioned in holes 6. This allows the sieve to be adjusted upward an additional 5 degrees.

8.0 TRANSPORTATION OF THE VERTI-TOP

The user is responsible for the transport of the Verti-Top behind the tractor when travelling on public roads. Check the national traffic rules.

In view of the weight of the Verti-Top, a maximum speed of 20 km/h (12.4 mph) should be observed while driving in open fields with the machine raised.

Higher speeds may endanger the driver and/or other people and even damage the machine.

* **When the machine is in the raised position, at least 20% of the weight of the tractor should be supported by the front axle.**

9.0 DRIVING SPEED

The driving speed is limited to 12 km/h (7.5 mph).

Higher speeds are not recommended in view of excessive wear and damage that may occur to the machine and the ground underneath.

10.0 OPERATION OF THE VERTI-TOP

Before the Verti-Top is used in the field, the following should be checked:

1. Are there any loose objects in the field? Remove these first.
2. Are there any slopes? The maximum slope this machine can work on is 20 degrees.
Always work downhill.
3. Is there any danger of flying objects, such as balls, which may distract the attention of the driver? If so, do **NOT** use the Verti-Top.
4. Is there any danger of sinking or sliding away? If so, postpone the work until the conditions are more favourable.
5. If the soil is very wet, the work should be postponed until the conditions are more favourable.
6. If the machine vibrates excessively, reduce the PTO speed.
7. A field can be done 2 or 3 times in the same direction or different directions to achieve better cleaning.
8. Do not make sharp turns; preferably drive in straight lines to avoid damaging the machine and/or the ground.

11.0 STARTING/STOPPING PROCEDURE

The starting procedure is **VERY** important. If this procedure is not followed exactly as described below, serious damage may occur to the ground underneath the machine.

The start procedure is as follows:

1. Check the Verti-Top thoroughly for loose parts and make sure all parts function properly.

***!! If parts are found that are loose or do not function properly, correct the situation before using the Verti-Top!!**

2. Drive to the place where the soil is to be treated.
3. Adjust the working depth while the machine is stationary as described in section 6.0.

***!! Ensure that the tractor is well blocked and cannot start moving by itself !!**

***!! Switch off the tractor before getting off !!**

4. Lower the machine until it hangs approximately 50 mm above the ground.
5. Shift the tractor to the correct gear.
6. Switch on the PTO at a low speed (rpm).
7. Slowly raise the PTO speed to approx. 300 rpm.
8. Drive the tractor forward and lower the Verti-Top smoothly onto the pre-adjusted rollers.
9. Raise the PTO speed to a maximum speed of 500 rpm.
10. Increase the driving speed to a maximum of 12 km/h (7.5 mph).

Stopping is done as follows:

1. While still moving, raise the machine smoothly until it is approximately 50 mm above the ground.
2. Disengage the PTO and raise the machine further.
3. Drive to the following location and begin again as described above.

12.0 EMPTYING THE WASTE CONTAINER

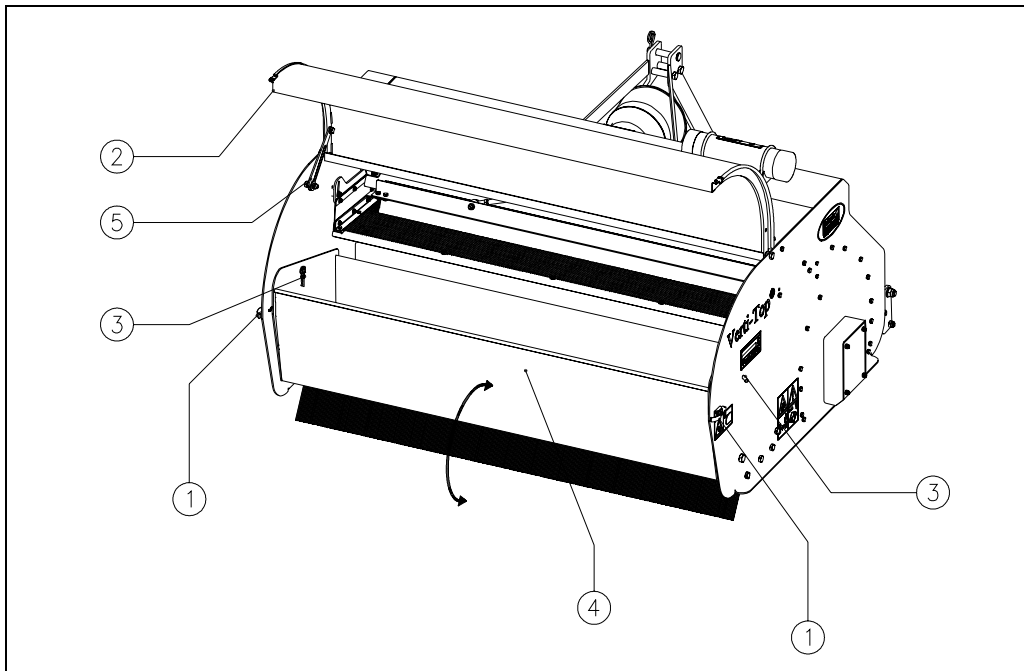

Fig. 13

When the waste container is full it must be emptied.

This is done as follows (see Fig. 13):

1. Drive the Verti-Top to the dumping location for collected waste.

***!! Ensure that the tractor is well blocked and cannot start moving by itself !!**

***!! Switch off the tractor before getting off !!**

2. Open the covers 1 on both sides of the Verti-Top.
3. Open the inspection panel 2 and lock it in retaining strip 5.

***!! Make sure the inspection cover is secured properly and cannot fall closed!!**

4. Remove pins 3 along with the safety clips from the side panels of the machine.
5. Carefully tip the waste container 4 until it rests against the bottom stoppers.
6. Remove the waste from the waste container 4.
7. Tip the waste container 4 back into the upright position.
8. Install pins 3 and the safety clips.
9. Unlock the inspection cover 2 from the retaining strip.
10. Carefully close the inspection cover 2.
11. Lock the inspection cover 2 with the closures 1 on both sides of the machine.

@ Dispose of the waste in the manner prescribed by local regulations.

13.0 DISCONNECTING THE VERTI-TOP

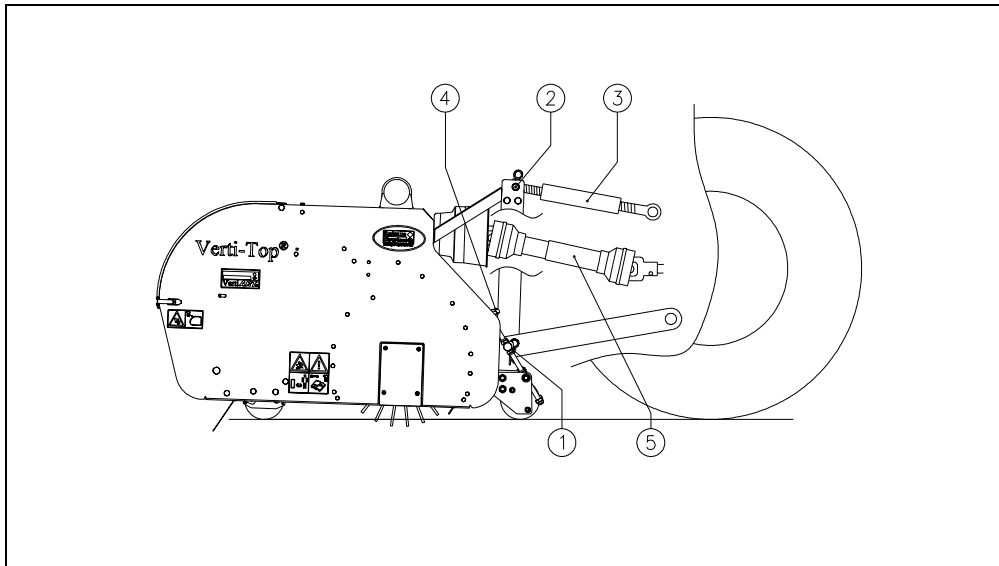

Fig. 14

The machine can be disconnected from the tractor as follows (See Fig 14):

1. Drive the Verti-Top up to its storage place, which must have a stable and flat ground.

!! Ensure that the tractor is well blocked and cannot start moving by itself !!
!! Switch off the tractor before getting off !!

2. Loosen the front roller adjustment 4 to lower the roller as far as possible.
3. Carefully lower the Verti-Top onto the ground.
4. Release the top rod 3.
5. Remove the safety pin from pin 2. Remove the pin from the top-rod connection.
6. Disconnect the PTO 5.
7. Remove the safety pins from pins 1 and remove the pins.
8. **!! Make sure the Verti-Top is stable and cannot roll/slide away!!**
9. Start the tractor and drive it away from the machine.

@ **While placing in storage it is recommended that the brush not be allowed to touch the ground or other objects in order to prevent the bristles from being bent.**

14.0 TROUBLESHOOTING

Problem	Possible cause	Solution
Too much material is collected in the waste container.	PTO rpm too high. Sieve angle set too low. Working depth is set too deep. Sieve is blocked.	Lower PTO speed. Increase angle of sieve. (see section 7.0). Decrease the working depth. Clean the sieve.
Too little cleaning	Working depth is not set deep enough. Driving speed is too high. Brush is worn. PTO speed is too low. Outlet opening for brush is blocked. V-belts are slipping.	Increase the working depth. Lower driving speed. Adjust guide covers (see section 16.2) Replace brush. Increase the PTO speed. Remove blockage. Tighten V-belts (see section 16.1).
Poor appearance of field after completion.	Working depth is set too deep. Drag brush damaged.	Decrease the working depth. Replace or repair.
Sieve bumps against side plates.	Incorrect alignment of sieve.	Centre the sieve.
Cracking noises during use of the machine.	Bearings require lubrication or are worn.	Lubricate the bearings with an EP2 grease or replace the bearings.

15.0 EU CERTIFICATE

We, Redexim BV, Utrechtseweg 127, 3702 AC Zeist, The Netherlands, declare entirely on our own responsibility that the product

VERTI-TOP WITH MACHINE NUMBER AS INDICATED ON THE MACHINE AND IN THIS MANUAL.

to which this declaration applies is in conformity with the standards NEN-EN-ISO 12100-1, NEN-EN-ISO 12100-2 and NEN-EN 294 in accordance with the stipulations of the machine directive 98/37/EC.

A.C. Bos
Manager Operations & Logistics
Redexim Holland

16.0 MAINTENANCE

Time schedule	Check point/lubricating point	Method
Before each use	<p>Check for loose bolts/nuts.</p> <p>Presence and legibility of safety stickers (Fig. 5)</p>	<p>Tighten the loose bolts/nuts with the correct torque.</p> <p>Replace if damaged or missing.</p>
After first 20 operating hours (new or repaired)	<p>Lubricate the roller bearings for the front and rear rollers of the driveline.</p> <p>Check for loose bolts/nuts.</p> <p>Check the tension of the V-belts.</p>	<p>Use EP 2 lubricating grease.</p> <p>Tighten the loose bolts/nuts with the correct torque.</p> <p>Adjust the tension of the V-belts if necessary. (see section 16.1)</p>
After every 100 hours of use or annually	<p>Lubricate the roller bearings for the front and rear rollers of the driveline.</p> <p>Check the gearbox for oil leakage.</p> <p>Check the oil level in the gearbox.</p> <p>Check for loose bolts/nuts.</p> <p>Check the tension/wear of the V-belts.</p> <p>Check the wear of the brushes.</p> <p>Inspect and lubricate the PTO.</p>	<p>Use EP 2 lubricating grease.</p> <p>Repair or replace.</p> <p>If necessary, fill to the level of the fill opening.</p> <p>Tighten the loose bolts/nuts with the correct torque.</p> <p>Adjust the tension of the V-belts. (see section 16.1). Or, if necessary, replace the V-belts.</p> <p>Rotating brush: If necessary, adjust the guideplates inward. (see section 16.2). If the adjustment limit has been reached, replace the brush.</p> <p>Drag brush: Replace or repair.</p> <p>See instruction manual for PTO.</p>

16.1 ADJUSTING V-BELT TENSION

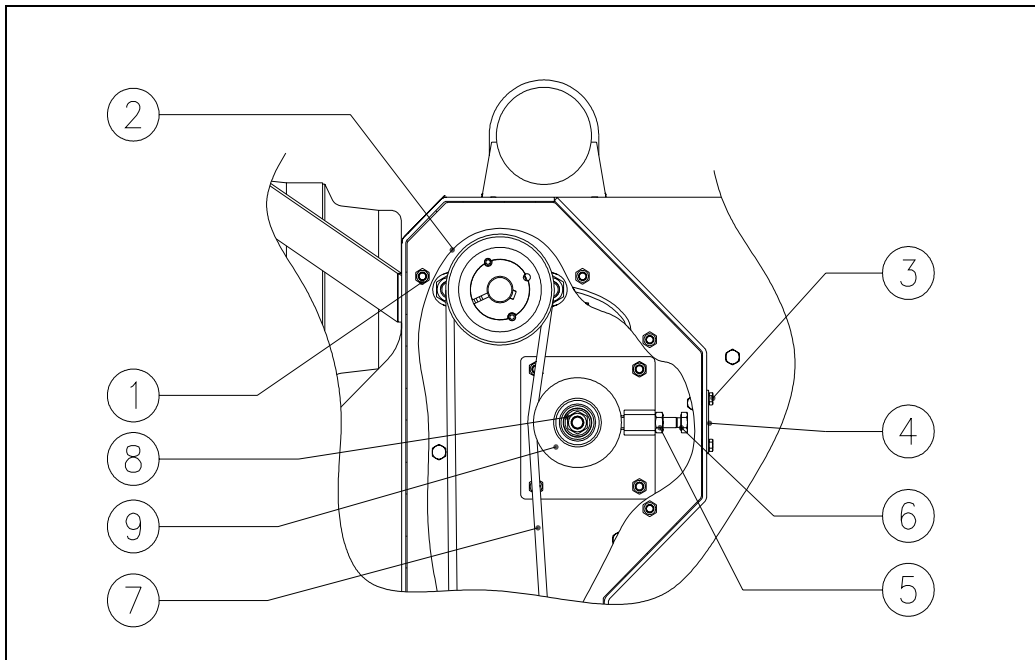

Fig. 15

The Verti-Top is equipped standard with an adjustable tensioning pulley that keeps the V-belts under tension.

As the machine is used wear occurs to the driveline.

This may lead to slippage of the V-belts, in which case they must be re-tensioned.

Adjustment can be accomplished as follows (See Fig 15):

***!! Ensure that the Verti-Top is well blocked and cannot start moving by itself !!**

1. Remove all nuts 1 and the safety cover 2.
2. Remove bolts and nuts 3 and remove the cover 4.
3. Loosen locknut 5.
4. Loosen nut 8 just enough to remove the tension.
5. Adjust the tension of V-belts 7 by turning bolt 6 to reposition tensioning pulley 9.
6. Tighten nut 8.
7. Tighten locknut 5.
8. Fit cover 4 and secure it with bolts and nuts 3.
9. Fit the safety cover 2 and install all nuts 1.

16.2 ADJUSTING BRUSH GUIDEPLATES

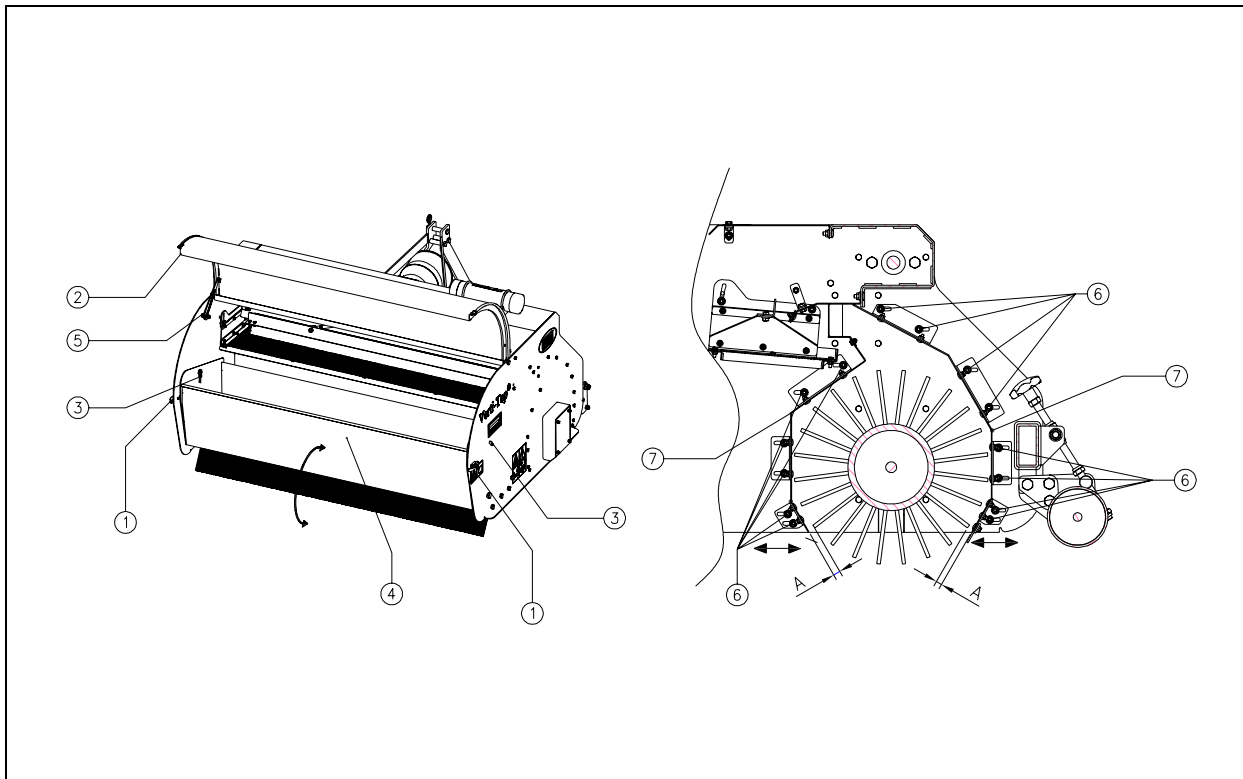

Fig. 16

As the Verti-Top is used, the brush will eventually wear.

As the wear progresses, the force of the air stream created by the brush will decrease and less material will be carried into the sieve.

To maintain the most effective air stream, the size of the brush chamber must be reduced.

The Verti-Top is equipped with a divided brush chamber in which the distance to the brush is adjustable.

Adjustment can be accomplished as follows (See Fig 16):

***!! Ensure that the Verti-Top is well blocked and cannot start moving by itself !!**

1. Open the covers 1 on both sides of the Verti-Top.
2. Open the inspection panel 2 and lock it in retaining strip 5.

***!! Make sure the inspection cover is secured properly and cannot fall closed!!**

3. Remove pins 3 along with the safety clips from the side panels of the machine.
4. Carefully tip the waste container 4.
5. Loosen bolts/nuts 6.
6. Slide the brush guideplates 7 evenly on both sides of the machine until distance A is approximately 15 mm.
7. Tighten bolts/nuts 6.
8. Tip the waste container 4 back into the upright position.
9. Install pins 3 and the safety clips.
10. Unlock the inspection cover 2 from the retaining strip.
11. Carefully close the inspection cover 2.
12. Lock the inspection cover 2 with the closures 1 on both sides of the machine.

16.3 EXCHANGING THE SIEVE

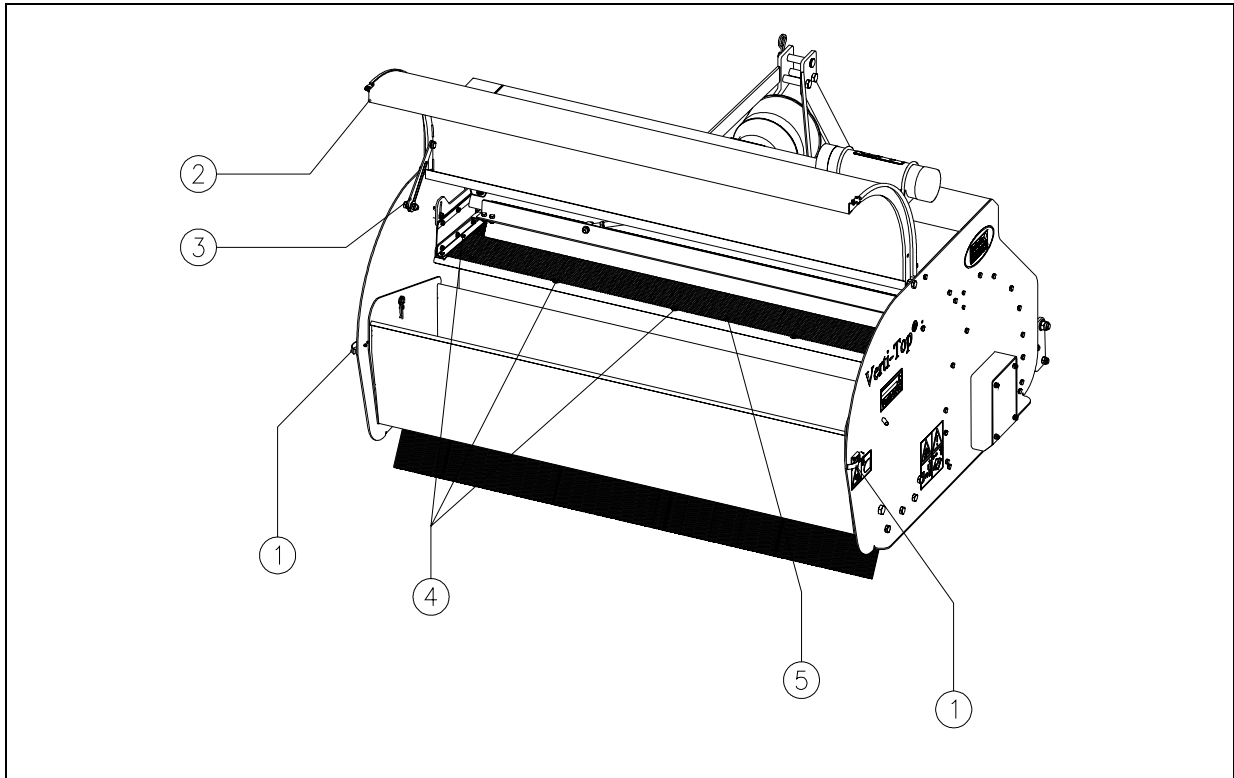

Fig. 17

If a different type of material is to be sieved or the material has dimensions for which the standard sieve is not appropriate, a sieve with a larger or smaller mesh width can be installed.

Adjustment can be accomplished as follows (See Fig 17):

***!! Ensure that the Verti-Top is well blocked and cannot start moving by itself !!**

1. Open the covers 1 on both sides of the Verti-Top.
2. Open the inspection panel 2 and lock it in retaining strip 3.

***!! Make sure the inspection cover is secured properly and cannot fall closed!!**

3. Loosen all of the bolts/nuts 4.
4. Remove sieve 5 and replace with another sieve.
5. Install bolts/nuts 4.
6. Unlock the inspection cover 2 from the retaining strip.
7. Carefully close the inspection cover 2.
8. Lock the inspection cover 2 with the closures 1 on both sides of the machine.